



O in Love
<https://www.hholove.com>

Automatic Cat Litter Box **Pro**

User Munual



Table of Contents

Important Safety Instructions	01-02
Specifications	03
Description	04
Production Installation	05-06
Button and Indicator	07
Wi-Fi Setup	08
App Introduction	09-10
Cleaning and Maintenance	11-13
Troubleshooting	14-15
Warranty and Service	16

Important Safety Instructions



Please read all instructions carefully before use.

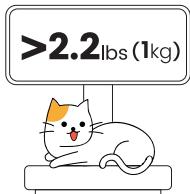

Cat or kitten must weigh at least 2.2lbs (1kg) and is aged 6 months or older to safely use the device.

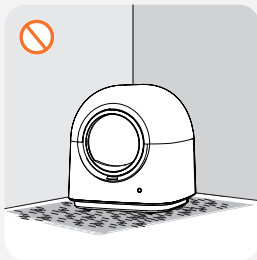

DO NOT place the device on carpet. Place it on a sturdy and flat floor and leave some space around it.

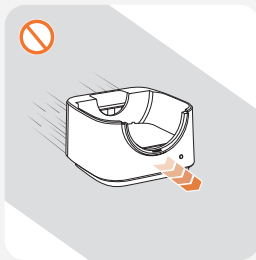

DO NOT drag the device. To avoid damaging the weighing sensor, please lift the base when moving it.



DO NOT rinse or immerse the base in water or other liquid.

1. This device is not intended to be used by persons (including children) with reduced physical, sensory or mental capabilities, or lack of experience and knowledge, unless they have been given supervision or instruction by person responsible for their safety.
2. Children under 6-year-old are not allowed to play with this device to avoid unpredictable risks.
3. Please use this device only for intended household purposes as described in this User Manual.
4. This device only supports 2.4G Wi-Fi. 5G Wi-Fi is not supported.

Important Safety Instructions

ELECTRICITY SAFETY

1. DO NOT use the device if it has a damaged power cord or plug, or if it is malfunctioning or has been damaged.
2. This device is only powered by the original adapter included in the package box.
3. DO NOT immerse the power adapter in water or other liquid.
4. If the supply cord is damaged, it must be replaced by the manufacturer or its authorized distributor, its service agent or similarly qualified persons in order to avoid unpredictable hazard.
5. Please unplug the device when not in use, before installing and removing its parts, and before cleaning, maintenance or repair it.

INSTRUCTIONS FOR USE

1. Place the litter mat in front of the device. Do not place the mat partially or completely under the device.
2. For indoor use only. Do not use this device in a high temperature and high humidity environment.
3. DO NOT sit on or place anything on top of the litter box.
4. DO NOT put anything in the device other than clumping litters that are small enough to pass through the sieve.
5. DO NOT allow cats to bite, chew on or swallow any parts, especially the power cord.
6. DO NOT open the cover lid while the litter box is rotating.
7. DO NOT attempt to disassemble, repair, modify or replace any part of the device privately. Any repair or maintenance must be performed by qualified personnel only.
8. DO NOT put foreign objects in the inner bin.
9. Dispose of all packaging materials properly. Keep away from children and pets.
10. Please wash your hands thoroughly after removing the waste. Those who are pregnant or with suppressed immune systems should note that a parasite sometimes found in the cat waste could cause toxoplasmosis. Please be cautious or consult with a physician before cleaning the waste.
11. It is recommended to replace the waste bag every 3 to 5 days to avoid bacteria growth.

Specifications



Input	DC 12V = 2A
Rated Power	7W
Targeted Cats	Weight 2.2-22lbs(1-10kg)/Age > 6months
Waste Drawer Capacity	1.5gal/6L
Toileting Space	15.9gal/60L
Max weighing capacity	44lbs/20kg
Applicable Litter	All clumping cat litter bentonite mineral, mixed and tofu cat litter (length<0.5in/1.2cm)

Description

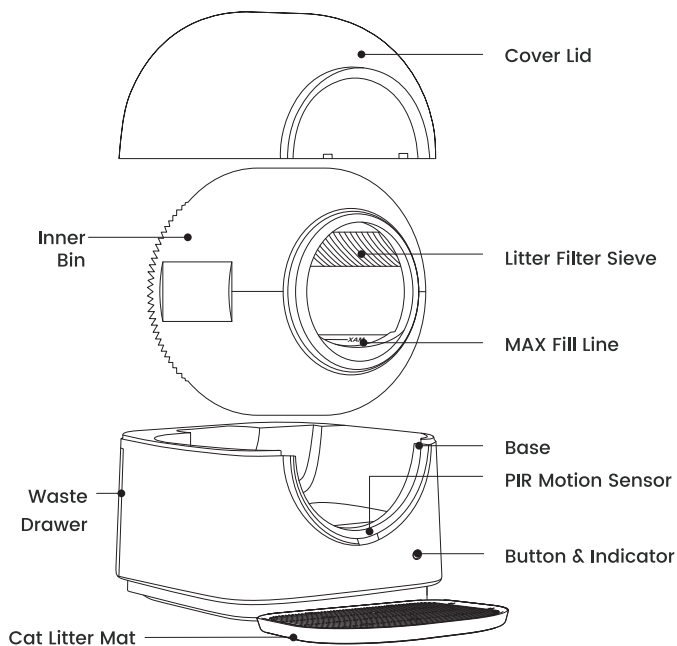

- Waste bag X1 (20 pack)
- User Manual x 1
- Quick Guide x 1
- Power Adapter x 1
- Deodorizer x 2

· Check all accessories before use.

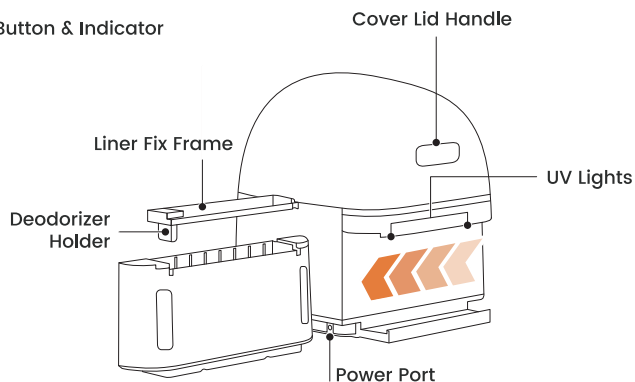

Production Installation



Make sure that the cover lid and waste drawer are properly installed in place before power on the device.

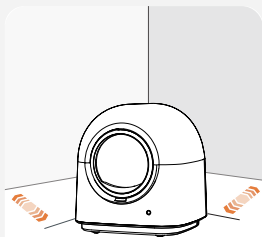

1

Place the device on a sturdy and flat floor, and leave some space around it. Do not cling to any walls.

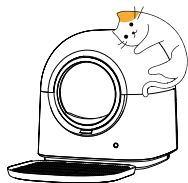

2

Place the mat in front of the litter box.

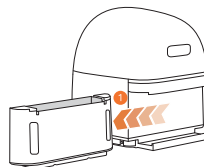

3

Slide out the waste drawer from either side.

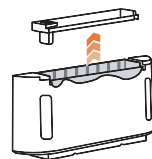

4

Remove the fix frame. Put a waste bag evenly inside and flatten all edges.

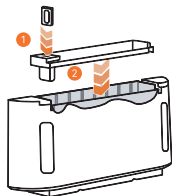

5

Put the deodorizer into the deodorizer holder. Insert the frame back with the holder on the correct side.

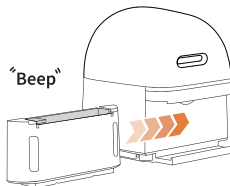

6

Slide the waste drawer back in place. You will hear a "beep" when the waste drawer is properly installed (if already connected to power).

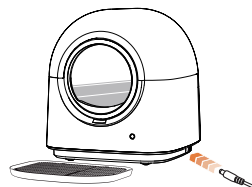

7

Power on the device and the bin will automatically rotate a full circle. Wait for it when rotation is completed.

* The device will automatically enter into pairing mode (indicator flashing in green) if it is used for the first time. Pair with your mobile as instructed in Wi-Fi Setup or use with button only.

! DO NOT OVERFILL

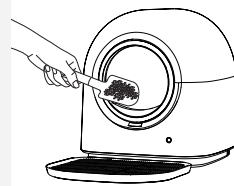

8

Add clumping litter up to the MAX line. Wait for the bin to automatically spread out the litter for about 5 minutes.

* You can also press the button once to start cleaning to spread out the litter manually.

Tips to help your cat adapt to the new litter box:

Location is the key. Place the litter box in the same location as the old one, or leave the old one nearby for a short period of time. Do not throw the old device away until your cat adapts to the new device.

Use recognizable scents. Add a scoop of litter from the old device to the new one to make familiar scent for your cat.

Button and Indicator



Button Functions



Hold for 10s to bring into pairing mode or restore to factory settings.



Press once to start cleaning. If already started, press it once to pause.



Press twice to empty all litter. If already started, press it once or twice to pause.

Indicators Status



Solid green
standby mode



Flashing green
wi-fi setup in progress



Solid purple
UV sterilization in progress



Flashing purple
OTA upgrade is in progress



Solid blue
cat entry/weight change/adding cat litter



Flashing blue
network issue/disconnected



Solid red
lid or waste drawer not properly installed or scooping/litter changing paused



Flashing red
motor blockage



Off
unplugged/sleep mode

Wi-Fi Setup



- 1 Make sure that your smart device is connected to a secure 2.4GHz network and Bluetooth is enabled. Allow access to your Location during connection.
- 2 Make sure that the bin is at the Home position before connecting.
- 3 You can use the litter box with control button only or download App for more customizable functions.
- 4 The litter box can only be linked to one account. You can hold the button for 10s to pair it with another device, share the device with your family members on App.

App Introduction

Scan the QR code or
Search "HHOLOVE"



Android

iOS



1

Download App
register your account

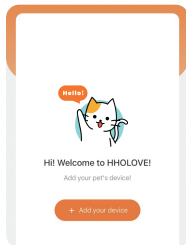

2

Add device

Adding Devices



Searching for nearby smart devices
Please try to bring your phone close to the smart device.

3

Find your device



Is the indicator light flashing green?

It is recommended that you keep your phone within 1 meter of the device, which will help you discover electronic devices more quickly.

4

Connect your device

Wi-Fi Connection

Please enter the Wi-Fi to connect Smart Litter Box
4314 to the network

Wi-Fi Proxy compatible with 2.4 GHz

XXXXXX

Password

5

Connect to Wi-Fi



6

Wait for connection

Device Connection



The device is connected successfully!

Relate your pet with this device so that we can take care of a better

7

Connection is
completed

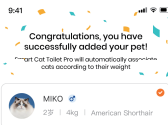

8

Fill in your cat's info

App Introduction

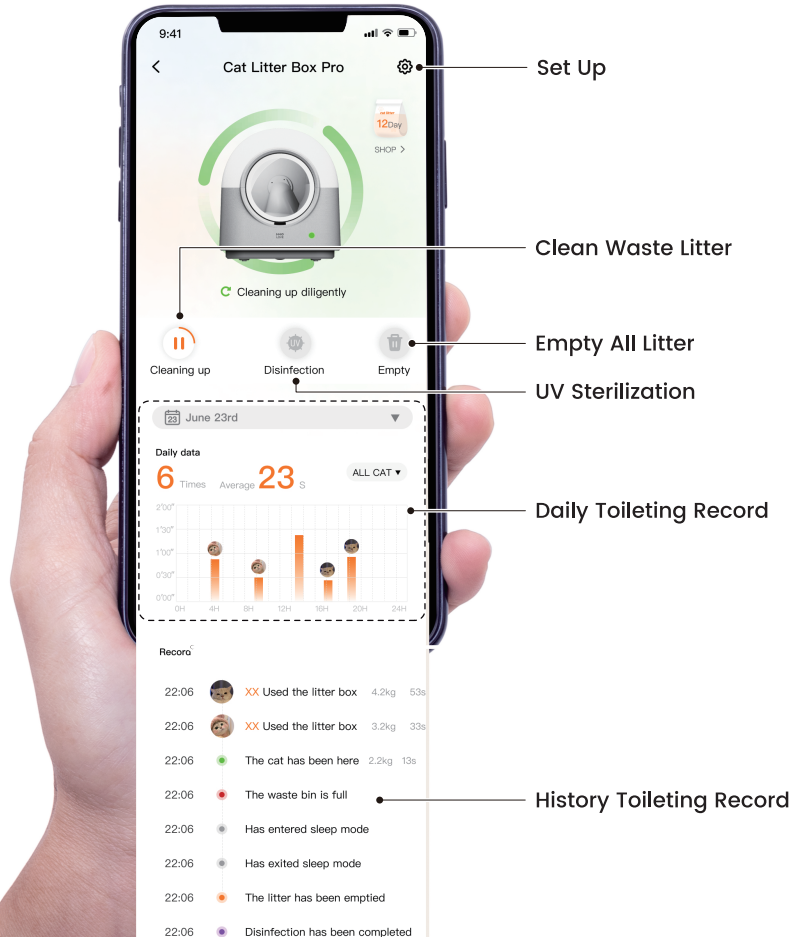

Cleaning and Maintenance

HOW TO REPLACE THE WASTE BAG



The frequency to replace the waste bag depends on the number and size of your cat(s). It is recommended to replace it every 3 to 5 days to avoid bacteria growth. Keep the waste bag away from children under 6-year-old.

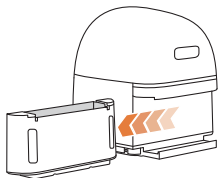

1

Slide out the waste drawer from either side.

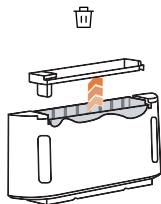

2

Remove the fix frame and take out the old waste bag.

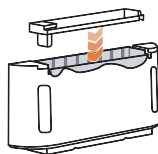

3

Put a waste bag evenly inside and flatten all edges, and then insert the frame back with the deodorizer holder on the correct side.

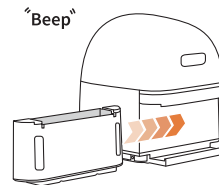

4

Slide the waste drawer back in place. You will hear a "beep" when the waste drawer is properly installed (if already connected to power).

Cleaning and Maintenance

EMPTYING AND CLEANING



- Make sure the waste drawer is empty before dumping **all** litter.
- The frequency to clean the device depends on your personal preference and your cat's behavior. It is recommended to clean the inner bin every one to three months.
- Dry **all** parts thoroughly before installing them back in place for future use.

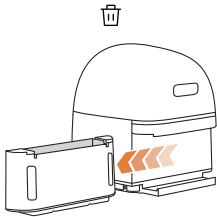

1

Slide out the waste drawer and dispose of the litter. Replace with a new waste bag and slide the waste drawer back.

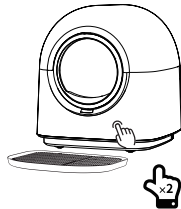

2

Press the button twice to start emptying all litter.

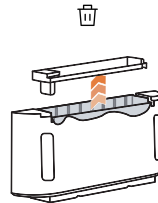

3

Wait until the empty cycle is done (bin stops rotating). Slide out the waste drawer and dispose of the litter.

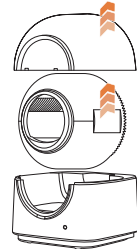

4

Unplug the litter box. Remove the cover lid and hold to take out the bin.

Cleaning and Maintenance

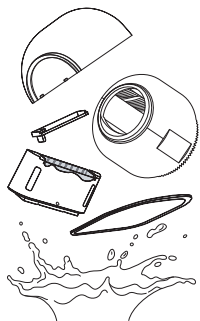

5

Rinse the bin, cover lid, waste bin and litter mat. Air dry thoroughly before reassembling.

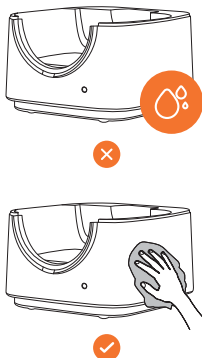

6

Clean the base with a soft and slight damp cloth or by wipes. DO NOT rinse or immerse in water.

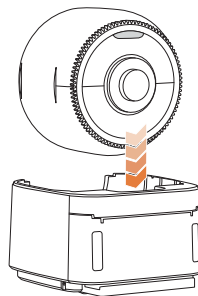

7

Place the bin back on the base, making sure that the bin handle is upward.

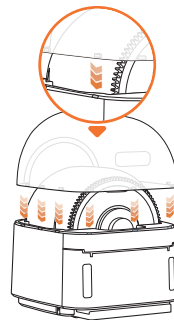

8

Align and place the cover lid back, making sure that the cover lid properly installed on the base.

Troubleshooting



The troubleshooting guide addresses the most common problems.

If problems persist, feel free to contact the Customer Support via email: service@hholove.com

PROBLEM

SOLUTION

Fail to connect the litter box.

- Check if your mobile is connected to a secure 2.4GHz Wi-Fi network and Bluetooth is enabled. Allow access to your Location during connection.
- Check if your mobile and litter box are connected to the same Wi-Fi network.
- Check if you input a correct Wi-Fi password and the litter box is under strong Wi-Fi signal.
- Check if the litter box is linked to another device. Hold the button on the device for 10s to reset or unbound the device on App.
- Check if a 5GHz Wi-Fi is used. Try a Personal hot spot, or change 5GHz to 4GHz to connect your mobile. Consult the router supplier for detailed instruction on router configuration.

Bin does not rotate or stops rotating suddenly.

- Disconnect from the power supply and remove the cover lid to check if there is any foreign object stuck at the gear of the bin.
- Make sure the bin is installed properly on the base. Reconnect it to the power supply and try again.
- The bin stops rotating automatically when cat or other unknown weight is detected. It will resume rotating after the cat leaves, or the weight is disappeared.

Troubleshooting

PROBLEM

SOLUTION

Indicator stays solid in red.

- Check if the cover lid and waste drawer are properly installed in place. You will hear one beep once properly installed.
- Check if the cat is approaching or enters the bin during cleaning or emptying. It will resume cleaning or emptying after the cat leaves.

Indicator flashes in red quickly.

Disconnect from the power supply and remove the cover lid to check if there is any foreign object stuck at the gear of the bin.

Waste drawer is empty, while the App warns it is full by mistake.

Please clean the two infrared sensors located around the UV light by wipes. The guideline is indicated in the App, please check it or contact us directly.

How to turn on UV sterilization?

- The UV sterilization is available on App only. There are two modes of sterilization. Manual sterilization: Tap Sterilization on homepage to sterilize once (about 10min).
- Smart sterilization: Tap Set Up on homepage then enable Smart Sterilization. Sterilization auto starts once every 6 hours.

Warranty and Service



Thank you for choosing HHOLOVE Automatic Cat Litter Box, the warranty will comply with the rules and regulations in the territories where you buy it.

The warranty does not include any case described as below:

- Accident, misuse, or repair and maintenance performed by unauthorized personnel.
- Any device that has been tampered with or refit, or used for commercial purpose.
- Wear and tear of wearable parts in daily operation.
- Damage caused by external forces, artificial damage, or damage caused by operations not complying with the User Manual, e.g. Connecting the device to an unsuitable power supply or non-compliance with the instructions.
- Partially or completely dismantle or refit the device.
- Defects caused by or resulting from damages from repair and maintenance, service, or alteration to the product or any of its parts that have been performed by a repair person who is not authorized.

After-sales service shall be provided only for products sold by HHOLOVE or HHOLOVE authorized retailers and distributors.

*** Please provide order ID when contacting Customer Support via email:** service@hholove.com

FCC Statement

This equipment has been tested and found to comply with the limits for a Class B digital device, pursuant to part 15 of the FCC Rules. These limits are designed to provide reasonable protection against harmful interference in a residential installation. This equipment generates, uses and can radiate radio frequency energy and, if not installed and used in accordance with the instructions, may cause harmful interference to radio communications. However, there is no guarantee that interference will not occur in a particular installation. If this equipment does cause harmful interference to radio or television reception, which can be determined by turning the equipment off and on, the user is encouraged to try to correct the interference by one or more of the following measures:

Reorient or relocate the receiving antenna.

Increase the separation between the equipment and receiver.

Connect the equipment into an outlet on a circuit different from that to which the receiver is connected.

Consult the dealer or an experienced radio/TV technician for help.

Caution: Any changes or modifications to this device not explicitly approved by manufacturer could void your authority to operate this equipment.

This device complies with part 15 of the FCC Rules. Operation is subject to the following two conditions: (1) This device may not cause harmful interference, and (2) this device must accept any interference received, including interference that may cause undesired operation.

RF Exposure Information

This equipment complies with FCC radiation exposure limits set forth for an uncontrolled environment. This equipment should be installed and operated with minimum distance 20cm between the radiator and your body.

Warnings and safety information

All information regarding the use of the product can be found in the user manual. Before using it, read its contents and follow the instructions contained therein.

Also read the following information before use:

Warnings for use

Risk of damage to the product:

- Only use the cuvette for its intended purpose as described in the operating instructions.
- Regularly check the condition of the unit, in particular the moving parts such as the screening mechanisms and the housing. In the event of visible damage, discontinue use and contact the service department.
- Do not place the litter tray in areas exposed to moisture, direct sunlight or extreme temperatures, unless otherwise indicated in the operating instructions.

Hazard to animals:

- Only use the litter tray for animals of the correct size and weight, as recommended by the manufacturer. Use of the litter tray by an animal that is too small or too large may cause discomfort or malfunction of the unit.
- Make sure the animal is comfortable using the litter tray - introduce the device gradually to avoid stress.
- If the unit malfunctions, switch it off immediately to avoid potential hazards to the animal, such as jamming in the moving mechanisms.

Risk to children:

- Automatic litter trays are not toys. Keep them out of the reach of children to avoid accidental damage to the unit or interference with its operation.
- Do not allow children to operate the appliance without adult supervision.

Risks associated with electronic components:

- Regularly check the condition of power cables and other electrical components. In the event of damage, discontinue use of the appliance.
- Avoid contact of the appliance with water unless the manufacturer indicates that the tray is waterproof.
- For models powered by batteries or rechargeable batteries, use only the manufacturer's recommended components and replace them in accordance with the operating instructions.

Information on correct use

Recommendations for use:

- Read the instruction manual before first use. Make sure that all components of the cuvette, such as the waste container and

screening mechanisms, are properly attached.

- Place the litter tray on a stable and level surface in a place that is easily accessible to your pet.
- Empty the waste container and clean the litter tray mechanisms regularly to ensure proper operation and hygiene.

Maintenance and storage:

- Store products in a dry and clean place, free from moisture and temperature extremes.
- Clean the litter tray regularly according to the manufacturer's recommendations, using soft materials and mild detergents. Do not use harsh chemicals or tools that could damage the unit.
- For models with waste bags, replace them as needed to avoid waste accumulation.

Battery safety:

- Use only batteries recommended by the manufacturer in battery-operated devices.
- Dispose of used batteries according to local environmental regulations.
- If the device will not be used for a long period of time, remove the batteries to prevent leakage.

Additional precautions

Adaptation to your pet:

- Observe your cat's reaction to the new litter tray - if your pet shows signs of anxiety or stress, gradually introduce the device.
- Make sure the device operates safely and does not cause discomfort to the animal, such as the mechanisms being too loud.

Damage and service:

- Any repairs to electronic devices should only be carried out by authorised service centres.
- Do not modify the product yourself, as this may affect its safety and functionality.

Declaration of conformity

The products have been designed in accordance with the safety requirements of Regulation (EU) 2023/988. They comply with the relevant technical standards, including safety in use, electromagnetic compatibility and durability of materials.

EU REP

HHO (Hangzhou) Digital Technology Co., Ltd.
Building 9, Haizhi Center, Yuhang District, Hangzhou City,
Zhejiang Province, P.R.China
service@hholive.com

Join HHOLOVE community to get the latest product information and giveaway treats.



Instagram



YouTube



x



Facebook

Product Name: Automatic Cat Litter Box Pro

Product Model: CL-TYW

Power Input: 12V=2A

FCC ID: 2A5DZ-CL-TYW



RoHS



R210-235862



For FAQ and more help,
please visit: <https://www.hholove.com/support>



Email Contact:
service@hholove.com

HHO (Hangzhou) Digital Technology Co.,Ltd.

Address: Building 9, Haizhi Center, Cangqian Street, Yuhang District,
Hangzhou City, Zhejiang Province, China

Designed by HHO

Made in China



©HHO Limited, all rights reserved. HHOLOVE and its logo are trademarks
of HHO Limited, registered in the US, EU and other countries.