

ROJECO

Automatic Pet Feeder

User Manual

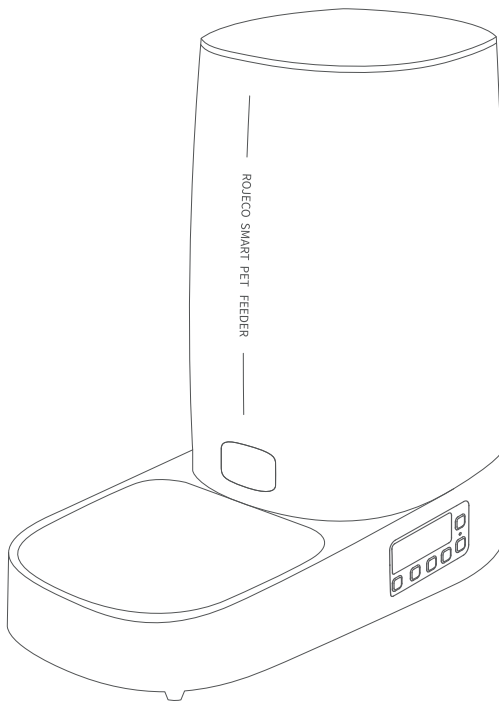

Model: PTM-003(Button Version)

Please read this manual carefully before using.

Product Description

Front View

- 1. Lid
- 2. Desiccant Box
- 3. Lid Lock
- 4. Detachable 4L Hopper
- 5. Food Outlet
- 6. Stainless Steel Bowl
- 7. Food Tray
- 8. Control Panel
- 9. LED Screen

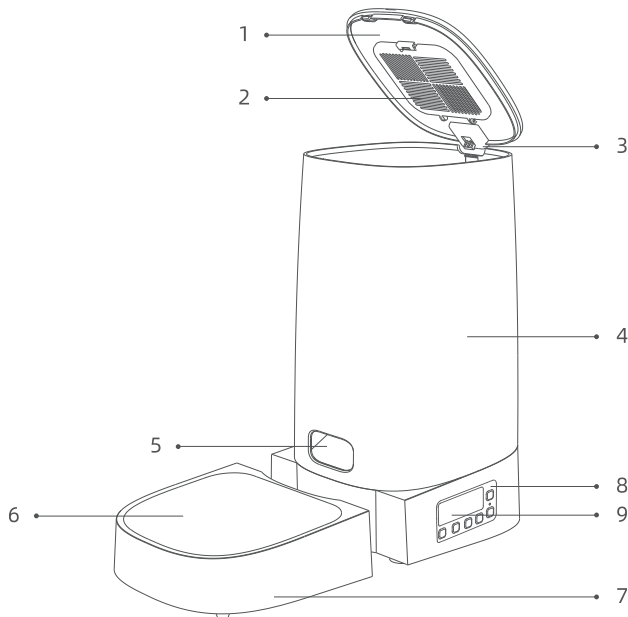

Bottom View

- 10. Hopper Release Lock
- 11. Battery Cover
- 12. Charging Port

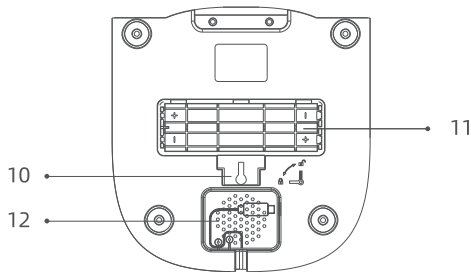

How To Assemble Feeder

- 1.Remove the components which are stored inside the food hopper.

Note: it is better to clean and dry all components completely before assembling feeder.

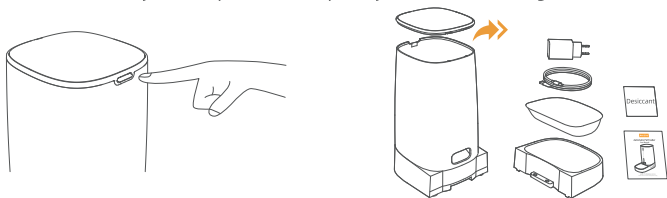

- 2.Plug in the power adapter. If you want, install 4*AA alkaline batteries (Not included) in case of a power failure.

Note: Batteries are powered for back-up only and should not be used as the main power source.

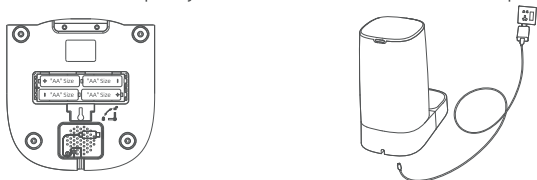

- 3.Place stainless steel bowl into the food tray.Lift feeder and slide the holder notch into the groove on the bottom of the feeder.Place Desiccant bag into the Desiccant Box.

Note: It's recommended to use a desiccant bag and change them every 30 days, Please remove the desiccant bag before cleaning the lid.

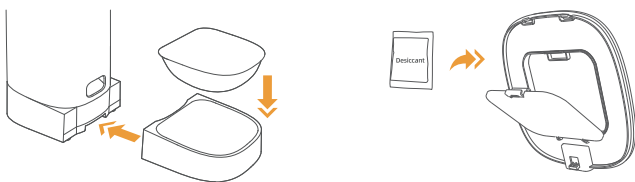

- 4.Fill the hopper with your pet's favorite dry food , reorganize the food to be plat and close the lid.

Note: Suitable for dry food with kibble size ranging from 4-12mm/0.16-0.47in in diameter. Larger kibble may get stuck at the food outlet.

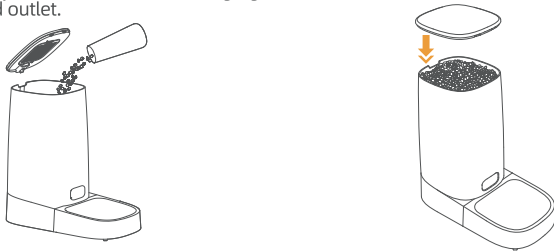

Cleaning & Maintenance

(1) Remove the lid and take out the desiccant.

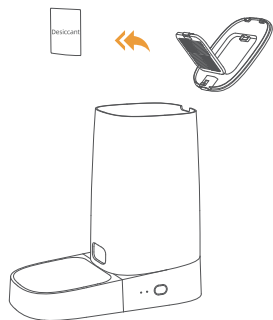

(2) Remove the bowl and empty the grain in the hopper.

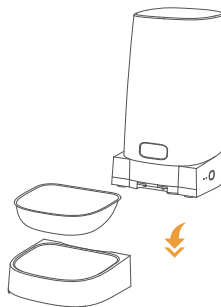

(3) Remove the battery door and rotate the hopper release button on back of feeder then lift to remove.

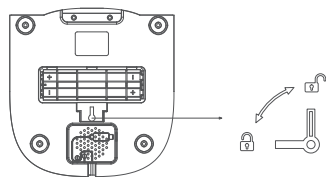

The base unit cannot be submerged in water. just use cloth to wipe up.

Food tray, stainless bowl, hopper and lid can be washed by water.

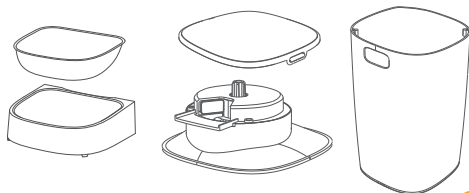
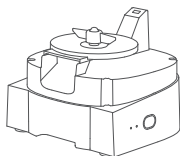

Assemble Two-way Splitter

(1) Place the Two-way Splitter in a desired location, check the food tray is in place.

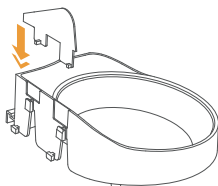

(2) Align the holes of the food tray and bulging in the base, and push downward to connect the two.

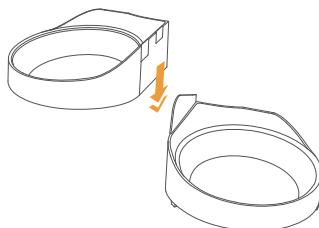

Components

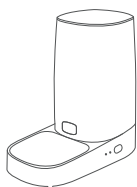

Pet Feeder

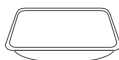

Food Stainless Bowl
& Tray



USB Plug



Type-C Cable



Desiccant Bag



User Manual

Specifications





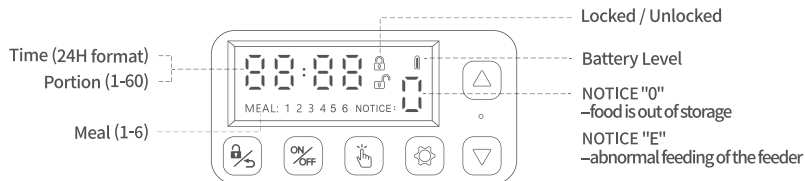

Model	PTM-003 Simply Feeder
Power	AC110-240V input; DC 5V 1A output
Dimensions	13.2*13*7in / 33.5*33*17.7cm
Dual Power Supply	USB Plug/ 4*AA batteries (Not included)
Material	ABS / SUS 304 / PC
Capacity	4L(only dry food or $\leq 20\%$ freeze dried)
Food Size	0.16-0.47in/4-12mm in diameter
Options	PTM-003 Version:1-60 portions;6g per portion; 6 meal per day

Button Version Troubleshooting

Problem	Solution
Can't press any buttons?	This feeder is a low-energy product. The screen will lock and goes off when there's no operation in 60s. The programmed meal will dispensing freely with the screen off. The LED screen will light up but stay locked when you press any button. Please press and hold the "lock" button for 3s to unlock the screen.
Can't remember the meal settings?	Unlock the screen, please press and hold the ON/OFF button for 3s, you can see all meal settings. Note: The screen will exit setting when there's no operation in 10s. Press the "setting" button again to enter the setting interface.
LED screen shown "E" or "0"?	Portion "0" appears on the screen to indicate that the food is out of storage. Please refill with food in time. Otherwise, the feeder will no longer dispense food. Portion "E" appears on the screen to indicate abnormal feeding of the feeder. Please check whether there are foreign objects in the hopper or the food is too large.
The feeder can't dispense food?	<ol style="list-style-type: none"> 1) Please be sure to fill in with dry food; kibble size should range from 0.16-0.47in / 4-12mm in diameter. 2) Check whether there is too much food in the food tank and the food passage is blocked. 3) Check whether any objects are put into the food tank by mistake, then check the rotor and food outlet. 4) Check whether it's at low battery level-whether the power adapter is connected or there is any power failure without battery installed. 5) Check the feeder set and save the correct local time before setting the feeding schedule. <p>If you follow the above all points, but the device still does not distribute food on schedule, please contact us for further assistance.</p>
Food volume for each portion is not the same?	The portions may vary at first few times and it doesn't mean a faulty equipment. After about feedings 6 times it should be almost same.
How to reset factory setting?	In the Unlocked mode, press and hold the (✨) + (▲) button for 6s at the same time to restore the factory settings.

Operation Interface



Button	Description	Operation Introduction
	Lock/Unlock	1. Press and hold for 3s at the same time to lock/unlock. The screen will be locked automatically after 60s without operating. 2. Short press will return to the previous step. Unlocked Mode: Only press the "up" and "down" buttons to view the feeding plan for each meal.
	Show/hide	Unlocked Mode: Press and hold for 3s to Show / hide feeding plan.
	Manual Feeding	Unlocked Mode: Short press will manually feeding once, press the button multiple times in a row will manually feeding multiple portions of food.
	Setting	Unlocked Mode: 1. Long press for 2s to set current time or exit setting mode. 2. Short press to set the feeding parameters. Press to switch between time / meal / portion settings, and when the specific icon blinks on the Screen indicating it's ready setting. 3. Press and hold for 2s to confirm and finish setting or wait 10s to exit program automatically.
	Up	Setting Mode: Short press to increase a value. Locked Mode: View previous feeding plan.
	Down	Setting Mode: Short press to decrease a value. Locked Mode: View next feeding plan.

Quick Programming Guide

Timer Setting

- Press (⏸) for 3s to unlock timer setting.
- Set timer according to the following picture.
- Press (⚙) to confirm and skip to next step, (▲) (▼) to modify number.

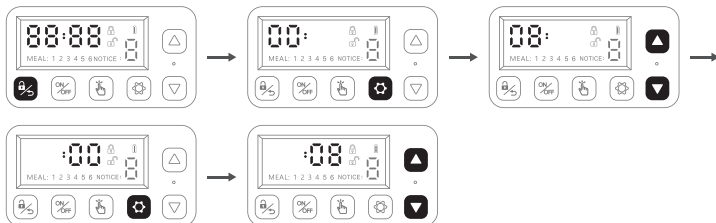

Meal Setting

1. Press () to set the feeding time of 1st meal, () () to modify number.

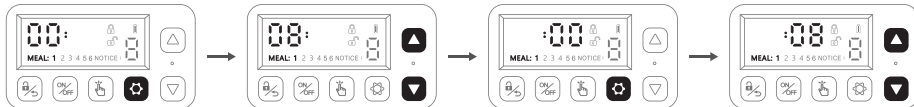

2. Press () to set the feeding portion of 1st meal, () () to modify number(1-60).

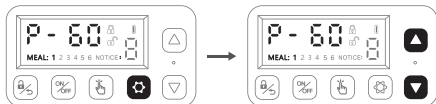

- 3.Repeat the above step to set 2nd~6th meal if need.Press and hold for 2s (✱) to confirm and finish setting or wait 10S to exit program automatically.

Note: Set the portion to 0 and the meal will be canceled.

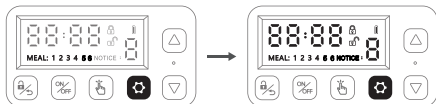



Scan to download the APP & log in

ROJECO Automatic Pet Feeder

Model: PTM-003

Manufacturer: Shenzhen Ipetmon Creative Technology Co.,Ltd.

Address: Industrial Zone B13, Liantang, Guangming, Shenzhen, China, 518106

Made in China



Please read this manual carefully and avoid causing errors or damaged. If you have any questions, please feel free to contact us via email: rojecoservice@126.com and include your order number in it. We'll get back to you as quick as possible.